

A.2.3

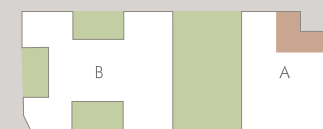

43,04
mq

Piano SECONDO
Corpo A

Appartamento (100%)	40,22	40,22
Giardini (33%)	-	-
Balconi/Logge (50%)	-	-
Terrazzi (33%)	-	-
Patii (33%)	-	-
Taverne (50%)	-	-
Sottotetti (50%)	-	-
Parti comuni (7%)		2,82



scala 1:100