

A.3.3

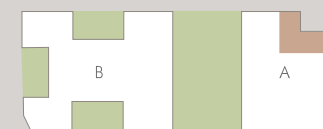

43,04  
mq

Piano TERZO  
Corpo A

Appartamento (100%)	40,22	<b>40,22</b>
Giardini (33%)	-	-
Balconi/Logge (50%)	-	-
Terrazzi (33%)	-	-
Patii (33%)	-	-
Taverne (50%)	-	-
Sottotetti (50%)	-	-
Parti comuni (7%)		<b>2,82</b>



scala 1:100