

**B.0.4+B.0.5**

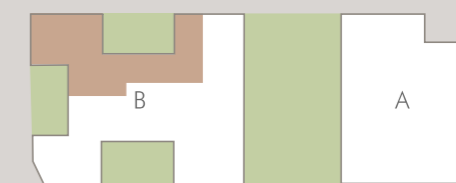

**192,55**  
**mq**

Piano **TERRA**  
Corpo **B**

Appartamento (100%)	134,73	<b>134,73</b>
Giardini (40%)	57,43	<b>22,97</b>
Balconi/Logge (50%)	-	-
Terrazzi (33%)	-	-
Patii (33%)	-	-
Deposito SPP (50%)	47,61	<b>23,81</b>
Parti comuni (7%)		<b>11,04</b>



PIANO TERRA

**B.0.4+B.0.5**

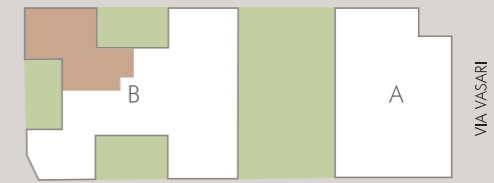

**192,55**  
mq

Piano **TERRA**  
Corpo **B**

Appartamento (100%)	134,73	<b>134,73</b>
Giardini (40%)	57,43	<b>22,97</b>
Balconi/Logge (50%)	-	-
Terrazzi (33%)	-	-
Patii (33%)	-	-
Deposito SPP (50%)	47,61	<b>23,81</b>
Parti comuni (7%)		<b>11,04</b>



PIANO INTERRATO -1