

B.0.6

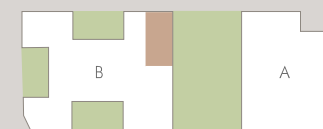

62,21
mq

Piano TERRA
Corpo B

Appartamento (100%)	43,77	43,77
Giardini (33%)	43,54	14,37
Balconi/Logge (50%)	-	-
Terrazzi (33%)	-	-
Patii (33%)	-	-
Taverne (50%)	-	-
Sottotetti (50%)	-	-
Parti comuni (7%)		4,07



scala 1:100